

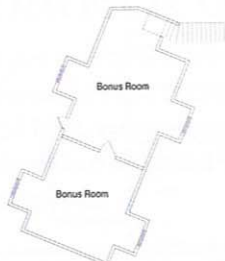

5500 Norman Road, Yakima, WA

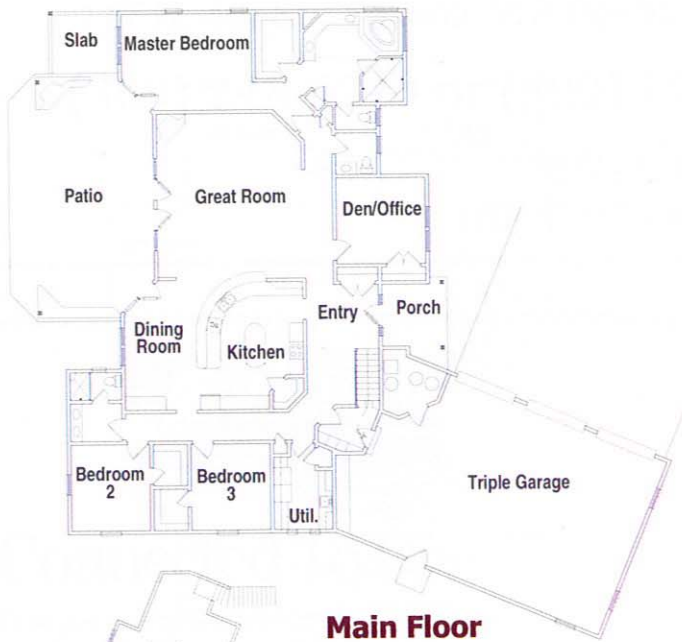

BTS Custom Homes is pleased to showcase the Reilands Home, a beautiful 3,015 square foot craftsman, with an 800 square foot bonus room, for the 2007 Yakima Tour of Homes™.

The home features four bedrooms, two and a half baths, great room, oversized bonus room, kitchen and garage all on a 2.5 acre lot with a view. As you arrive at the home you are greeted by a stamped concrete patio and designer garage doors. Once you enter, you can't help but notice the Brazilian cherry hardwood floors, tiled bathrooms, cherry cabinets, granite countertops in the kitchen, and crown molding with rope lighting. Outside the patio features stamped concrete and an exterior fireplace. This home is a must see on the tour!

Special thanks go out to the Reilands and our specialty contractors and suppliers.



Dave Palmer & Kevin Krutsch
509-961-0677

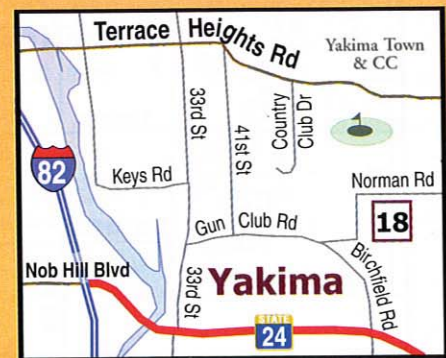

Directions: From Yakima, take E Nob Hill Blvd. East. E Nob Hill Blvd. will become Hwy 24 after crossing Interstate 82. Continue on Hwy 24 to Birchfield Rd. and turn left. Continue on Birchfield Rd. to Norman Rd. and turn right. The home is located at 5500 Norman Rd.