

R.A.S Contracting Corp

Category A

A welcoming Craftsman style home built by R.A.S. Contracting Corporation, with over 3750 sq. ft.. This one of a kind home is embellished with exquisite African Walnut hardwood flooring and beautiful stamped concrete. A full deluxe wet bar in the daylight walkout entertainment area and a stunning rock fireplace complete with solid wood mantle lend to the craftsman feel and ambience of the home. The kitchen is spacious and truly a cook's dream with solid, raised panel Hickory cabinets, crown molding, craft nooks, upgraded stainless steel appliances, concrete countertops with tile backsplash and deluxe walk-in pantry. Formal dining room sits adjacent to both great room and kitchen. Most every room breathes in the stunning Selah views and spacious patios and decks lend additional living space to this elegant yet comfortable home.

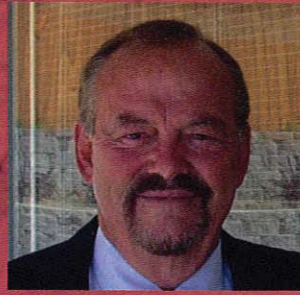

Roy Sample
509-697-8714

R.A.S Contracting Corp is a partner in the Pacific Power ENERGY STAR® New Homes program.



www.rascontracting.com



1401 W. Naches Avenue • Selah, WA

3,750 Square Feet

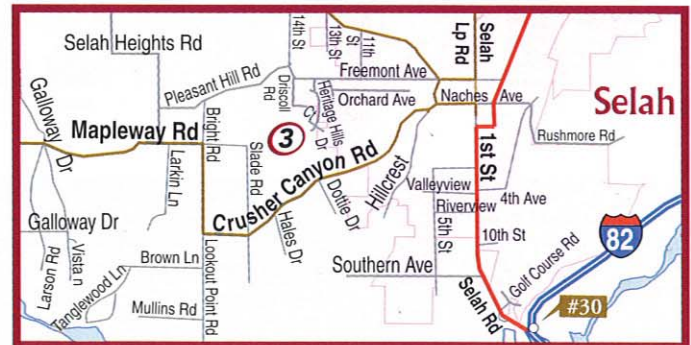
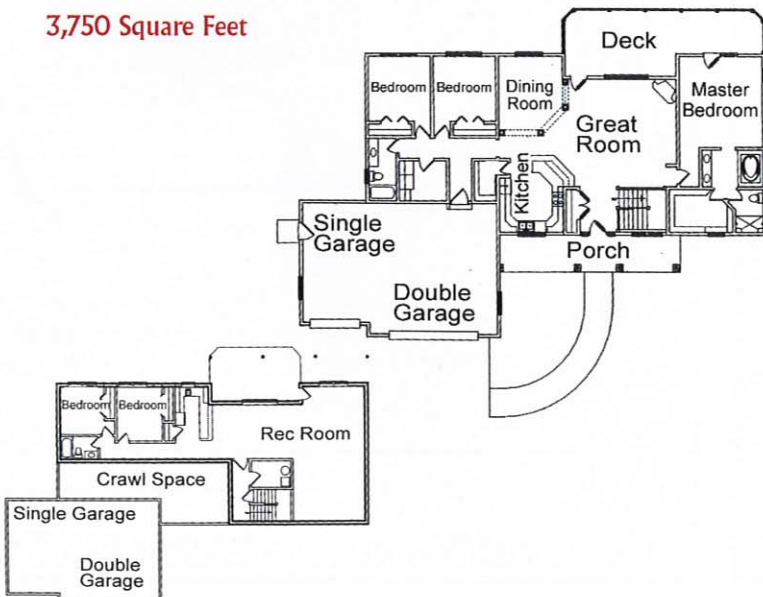

In Selah from 1st Street. At traffic light by 7-11 (1st. and Freemont) , turn left up Freemont Avenue. Turn left on 14th Avenue. House is on the right in the Heritage Hills Sub-division.